



**Studio Five**  
Specification

Studio	m	ft
Area of studio cove (m <sup>2</sup> /ft <sup>2</sup> )	480 m <sup>2</sup>	5165 ft <sup>2</sup>
Studio length	33	105
Cove length (wall to wall)	23	75
Cove width (wall to wall)	20	65
Cove length (flat floor)	21.5	70
Cove width (flat floor)	17.5	57
Ceiling return	3.5	11

Production/Working Area	m	ft
Length	10	25
Width	17	56

Studio Entrance	m	ft
External shutter height	4.6	15
External shutter width	5.2	17
Internal door height	2.2	8
Internal door width	2	4

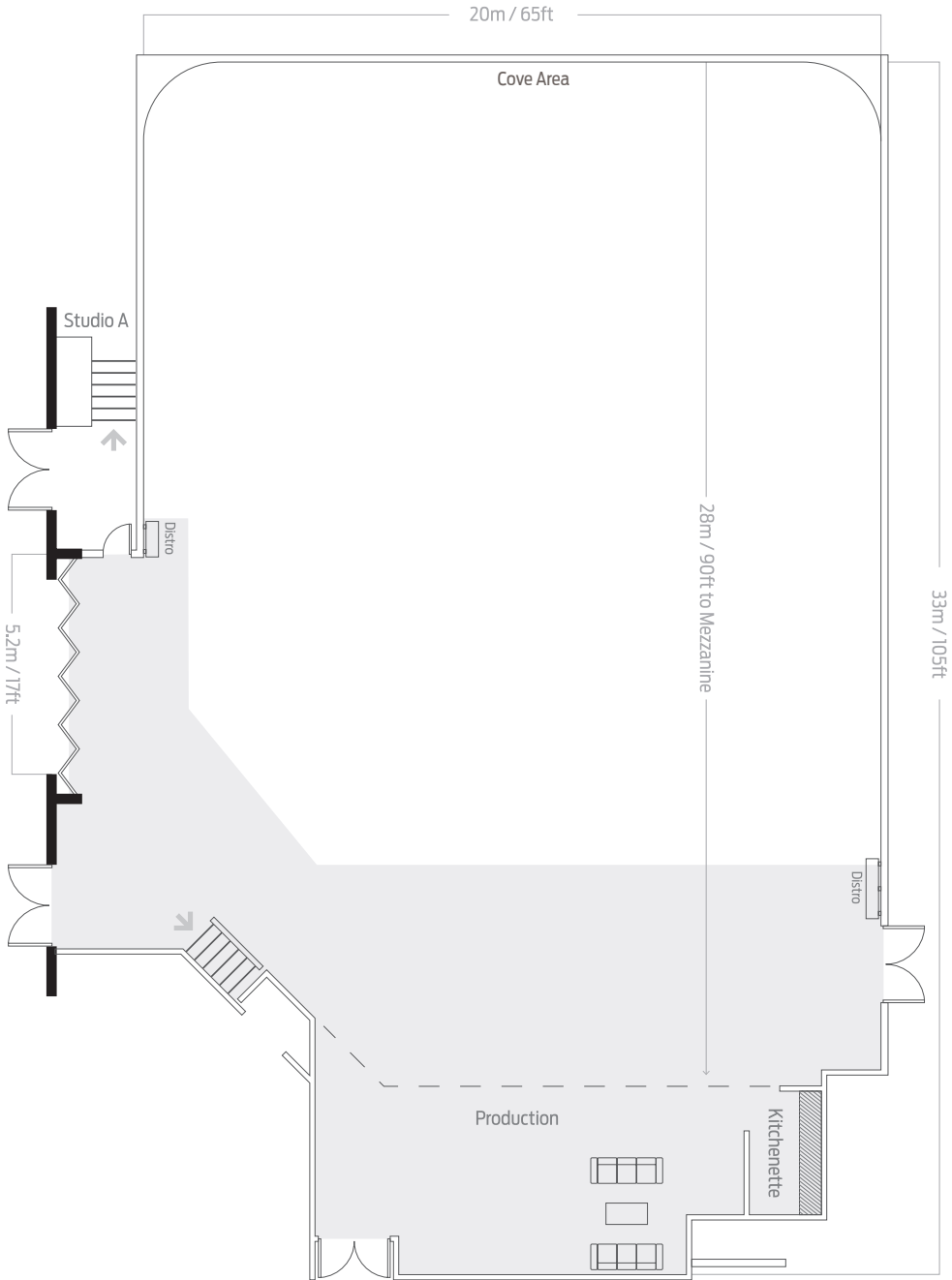

■ Park Royal Studios,  
1 Barretts Green Road, London. NW10 7AE

■ +44 (0)20 8965 9778 +44 (0)20 8963 1056  
info@parkroyalstudios.com www.parkroyalstudios.com

## Studio Five

Lighting Rigging & Floating Ceiling Specification

### Lighting Rigging

	m	ft
Distance from back of wall	3.5	11
Height	5.5	18
Width	15	49
Length	20	65

### Useful Information

- 'U' shaped infinity cove
- Drive-in Access
- Scaffold Rig
- Kitchenette facilities
- Green room
- Production facilities
- Mezzanine level including:
- Male/female shower WC/ facilities
- Air conditioned styling and makeup facilities
- Interlinks with Studio A
- 6 x 63amp single phase cee-form socket
- 6 x 32amp single phase cee-form socket
- 1 x 63amp 3 phase (5 pin) cee-form socket
- 1 x 32amp 3 phase (5 pin) cee-form socket
- 1 x 200amp 3 phase power locks

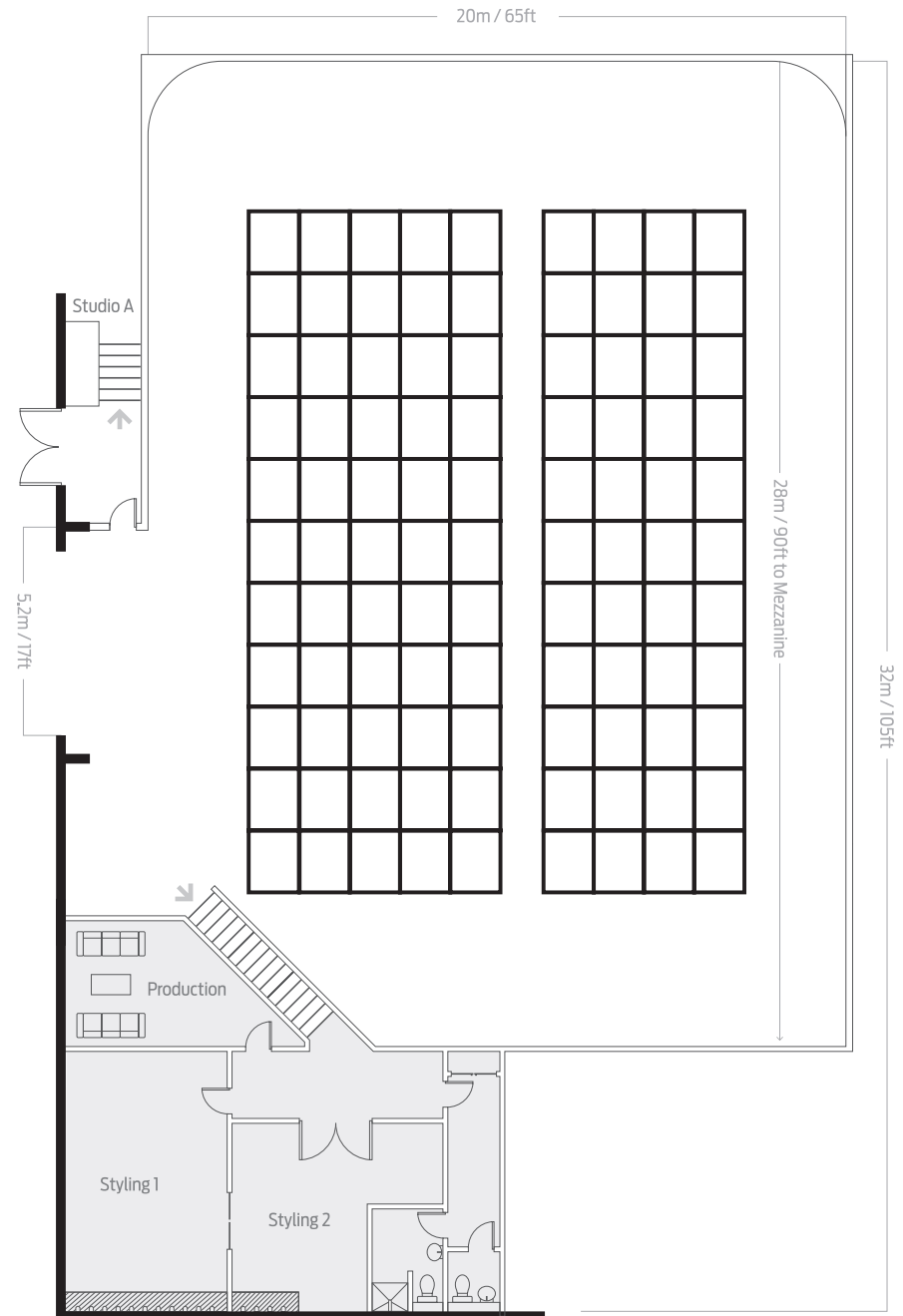

First Floor Mezzanine