

Studio 5

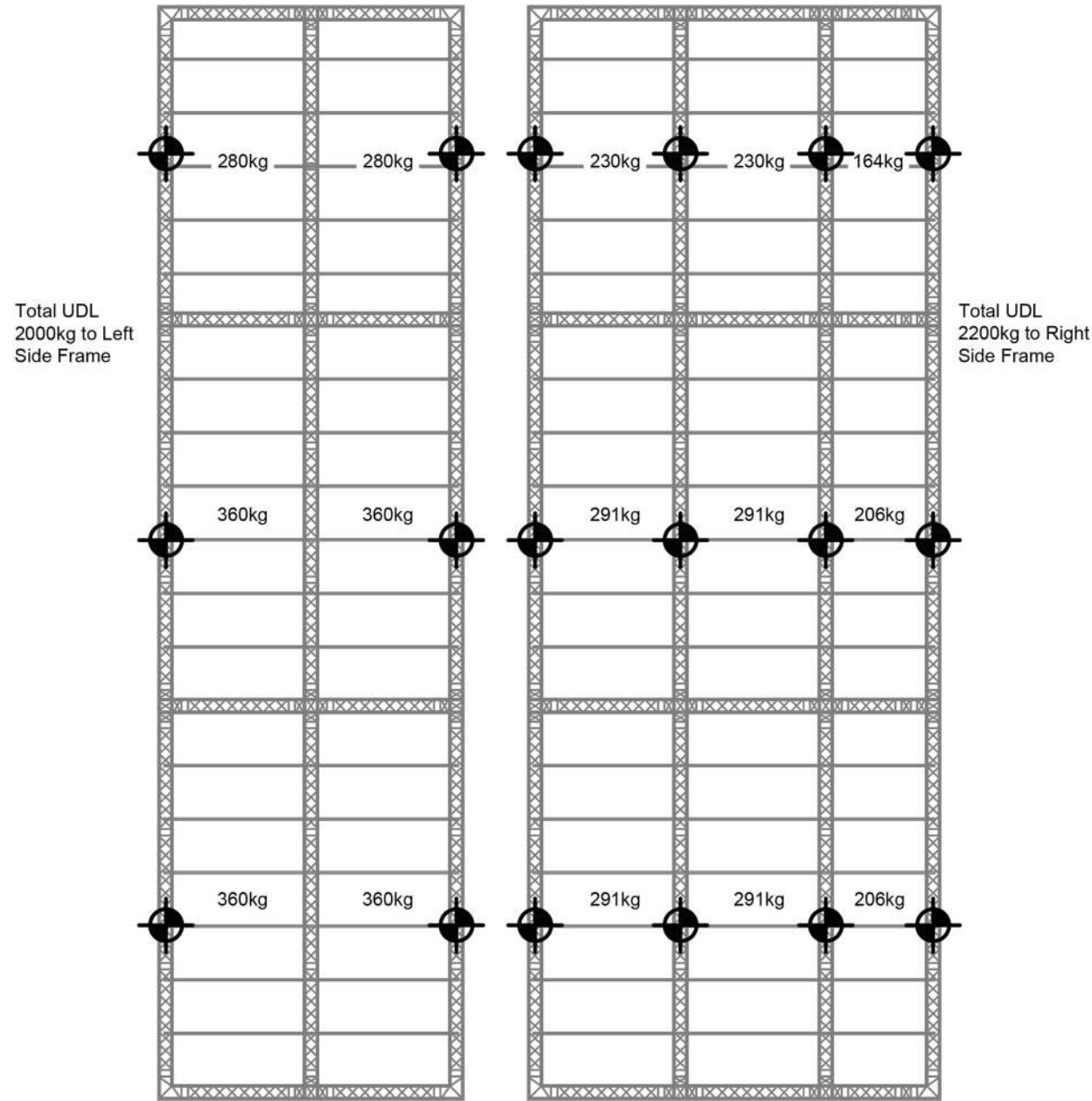

Studio 5 Max. SWL (No Rigging to Studio 3)

Scale 1:100

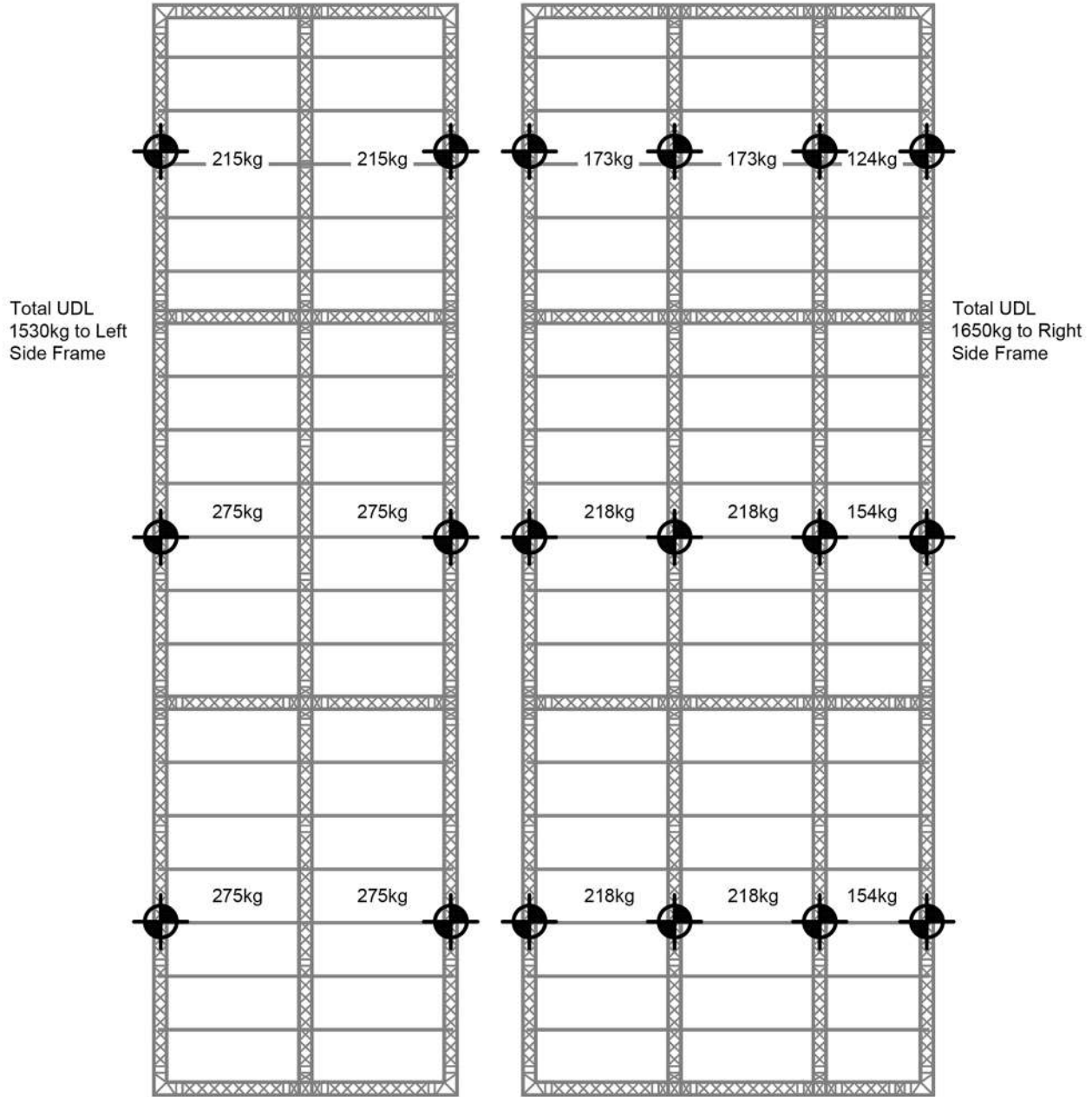

Studio 5 Max. SWL (Whilst Studio 3 is Rigged)

Scale 1:100

Key Plan

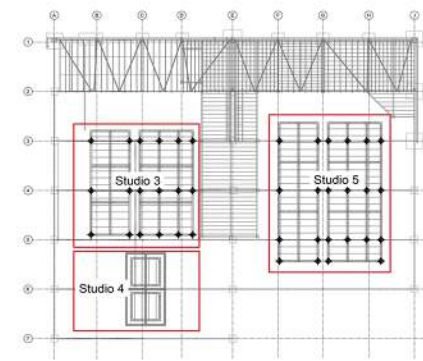

notes :

1. IF THIS DRAWING HAS BEEN RECEIVED ELECTRONICALLY IT IS THE RECIPIENTS RESPONSIBILITY TO PRINT THE DOCUMENT TO THE CORRECT SCALE
2. ALL DIMENSIONS ARE IN MILLIMETRES UNLESS STATED OTHERWISE. IT IS RECOMMENDED THAT INFORMATION IS NOT SCALED OFF THIS DRAWING
3. THIS DRAWING SHOULD BE READ IN CONJUNCTION WITH ALL OTHER RELEVANT DRAWINGS AND SPECIFICATIONS
4. ANY DISCREPANCIES NOTED ON SITE ARE TO BE REPORTED TO THE ENGINEER IMMEDIATELY.

P1	Preliminary Issue	AT	27.01.22
rev	amendments	by	date



Client:
Rigging Services

Project:
Park Royal Studios

Title:
**Studio 3
Maximum SWL Layouts**

Drawing Status: Preliminary	Date Created: Sept'21	Drawing Scale: As shown
---------------------------------------	---------------------------------	-----------------------------------

SP-469 / A1 / 006 **P1**

Project Leader: ML	Drawn By: AT	Initial Review: ML
------------------------------	------------------------	------------------------------