

Studio 5

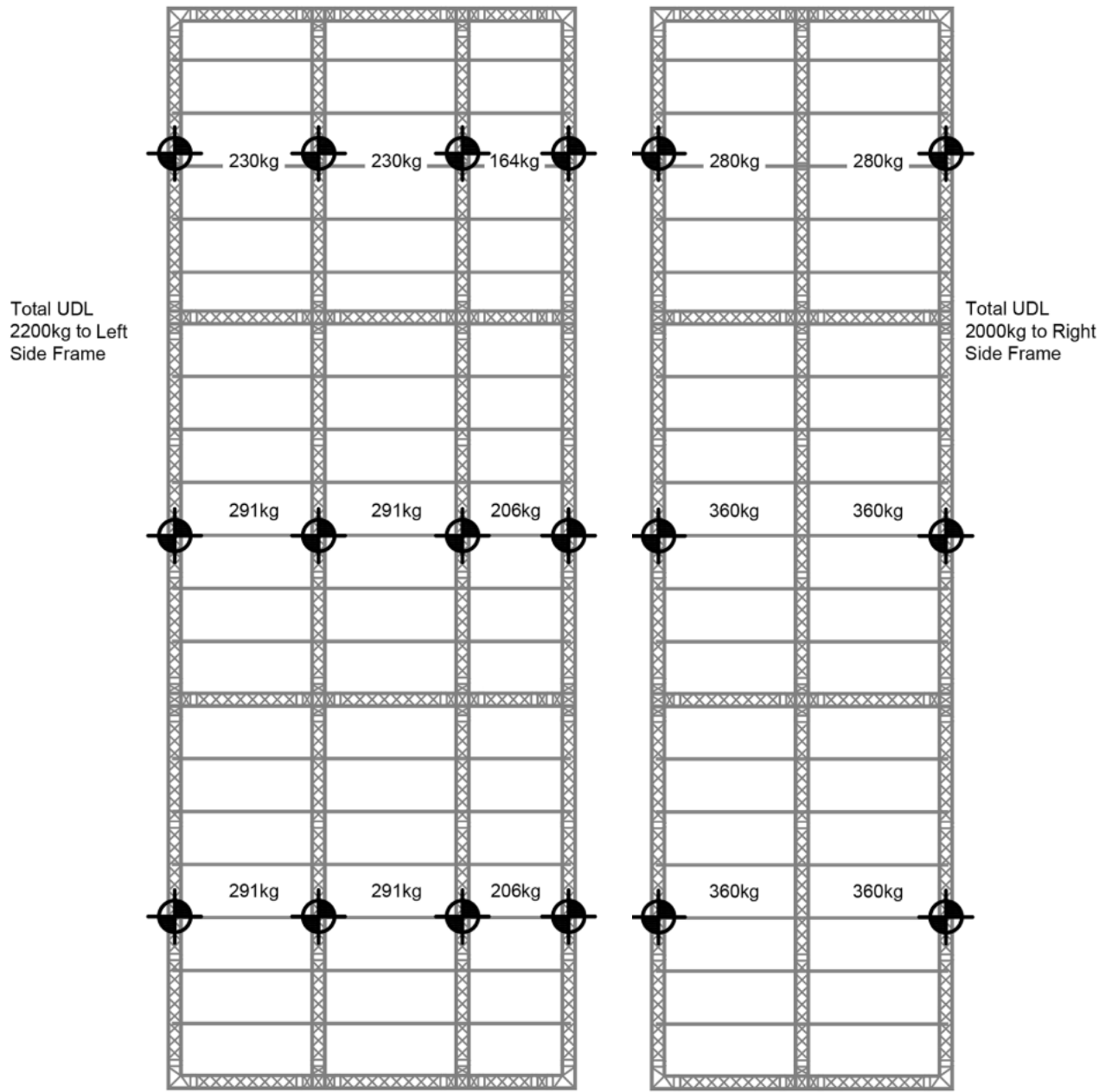

Studio 5 Max. SWL (No Rigging to Studio 3)

Scale 1:100

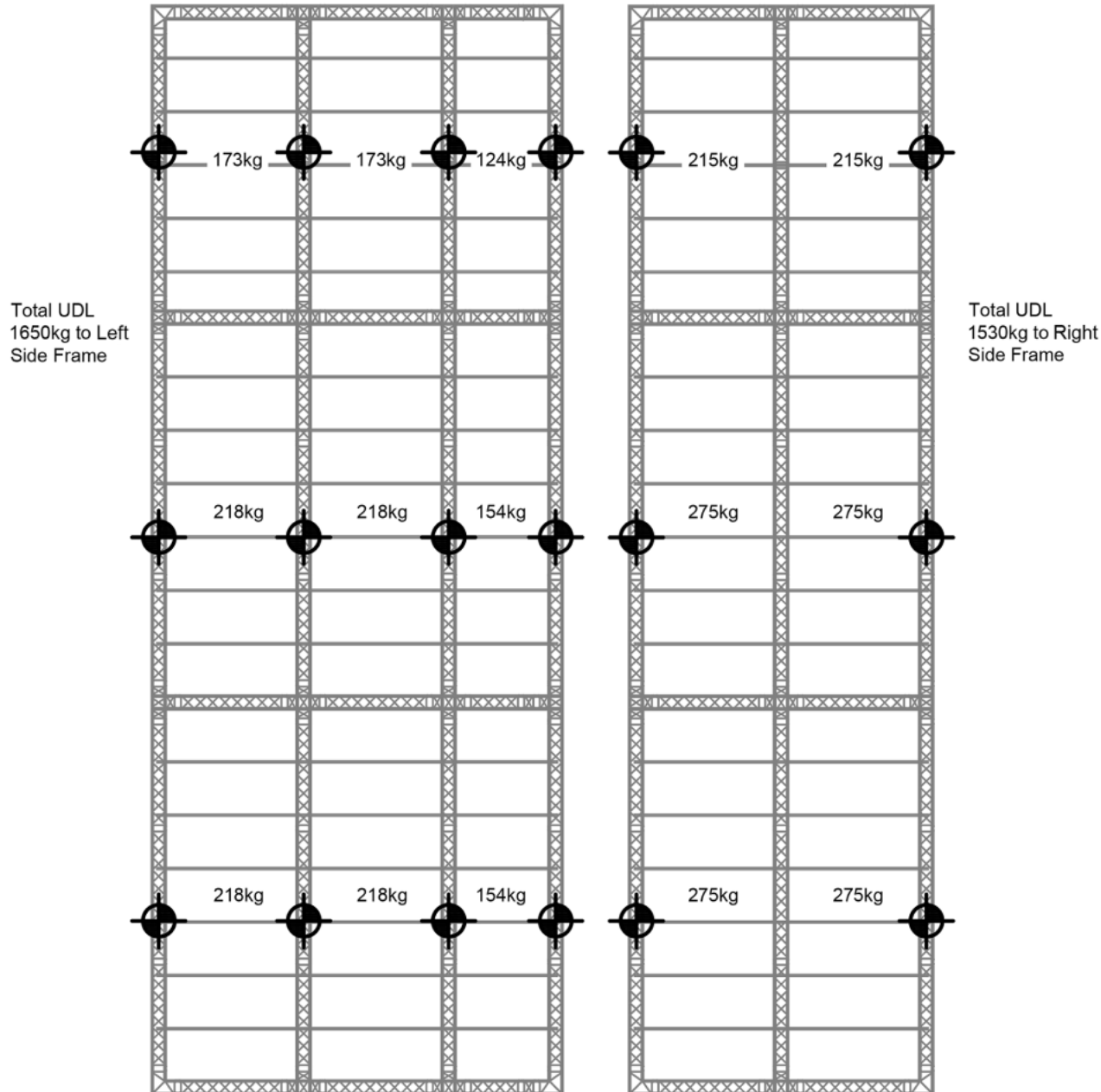

Studio 5 Max. SWL (Whilst Studio 3 is Rigged)

Scale 1:100

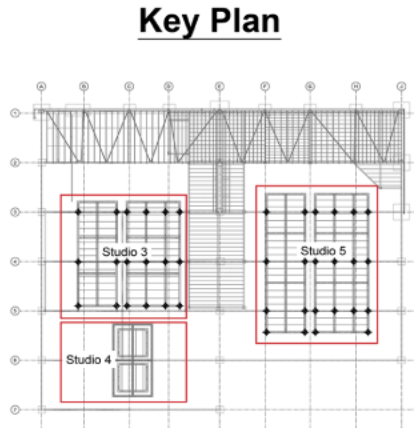

- notes :**
- IF THIS DRAWING HAS BEEN RECEIVED ELECTRONICALLY IT IS THE RECIPIENT'S RESPONSIBILITY TO PRINT THE DOCUMENT TO THE CORRECT SCALE
 - ALL DIMENSIONS ARE IN MILLIMETRES UNLESS STATED OTHERWISE. IT IS RECOMMENDED THAT INFORMATION IS NOT SCALED OFF THIS DRAWING
 - THIS DRAWING SHOULD BE READ IN CONJUNCTION WITH ALL OTHER RELEVANT DRAWINGS AND SPECIFICATIONS
 - ANY DISCREPANCIES NOTED ON SITE ARE TO BE REPORTED TO THE ENGINEER IMMEDIATELY.

P1	Preliminary Issue	AT	27.01.22
rev	amendments	by	date



Client: **Rigging Services**

Project: **Park Royal Studios**

Title: **Studio 3 Maximum SWL Layouts**

Drawing Status: Preliminary	Date Created: Sept'21	Drawing Scale: As shown
------------------------------------	------------------------------	--------------------------------

SP-469 / A1 / 006 P1

Project Leader: ML	Drawn By: AT	Initial Review: ML
---------------------------	---------------------	---------------------------