

park  
royal  
studios



**Venue:**

Park Royal Studios  
1 Barrett's Green Road  
London  
NW10 7AE

**Capacity:**

\*1200 (whole building)



park  
royal  
studios

park royal studios is  
one of the UK's leading film  
and photographic studios.



Located in NW London, within easy reach of major road networks and a short walk to an overground and tube line, Park Royal Studios is the perfect blank canvas to host your event.

The studios have recently undergone an extensive rebuild and renovation and now feature modern and spacious interiors, designed to appeal to the corporate events and conference sector. There are three large, versatile drive-in studios on the ground floor with options to interlink spaces, with a large restaurant and two further studios on the first floor.

There are a variety of styling and production rooms throughout the building, perfect for creating additional break out space, as well as large airy corridors which provide additional reception or cloakroom space. The studios have disabled facilities and have a wheelchair accessible lift to the first floor. There are two large car parks on site also providing ample parking for your guests.



**Our day delegate packages start from £65 per head\* (plus VAT) and contains the following:**

- Exclusive room hire
- Dedicated Venue Support Manager
- High Speed Wi-Fi
- \*\* Virtual Production
- Projector and screen
- One flipchart
- Three servings of Fairtrade coffee, Twining's tea, and a selection of biscuits
- Cold finger buffet, fruit, and juices
- Still and sparkling filtered water
- One hour gate attendant to welcome your guests upon arrival

\* Minimum number apply  
\*\* Additional fee applicable







## catering

If you wish to tailor delegate packages, our Head Chef is on hand to design the perfect menu to suit all budgets. From cocktails and canapes, street food to an evening black tie reception, our catering team can work with you to create exceptional catering to delight your clients.







## creative production

Our events team and production partners can provide a complete service to make your event a success. We have an in-house projection team, able to create virtual reality video mapping inside our studio coves, and other interiors, to turn the mundane into the spectacular. We will work with you from initial concept through to installation, to create an immersive experience which will make your event truly memorable.

We have locally based partners on hand for set building, venue styling, lighting, AV and major prop houses.

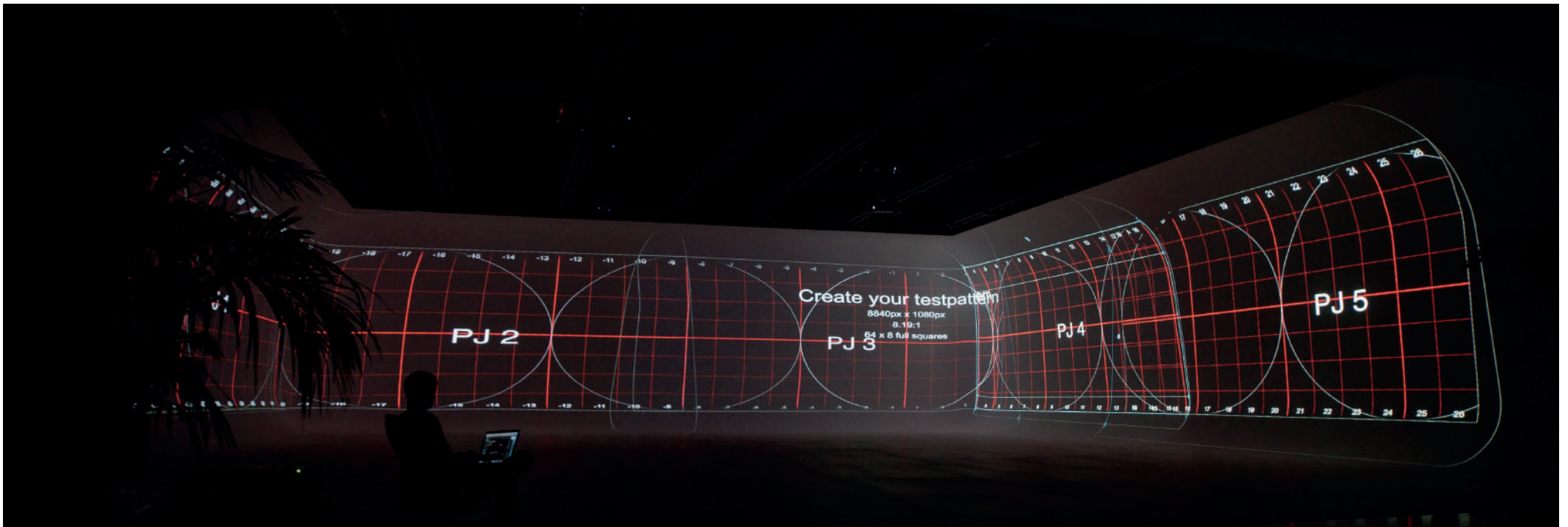

# capacities

	Studio A LINK	Studio B	Studio 3 LINK	Studio 4 LINK	Studio 5 LINK	Restaurant
Banquet (5ft)	60	60	540	220	500	180
Banquet (6ft)	60	60	500	200	460	170
Reception	60	60	700	290	700	220
Theatre	60	60	680	270	635	220

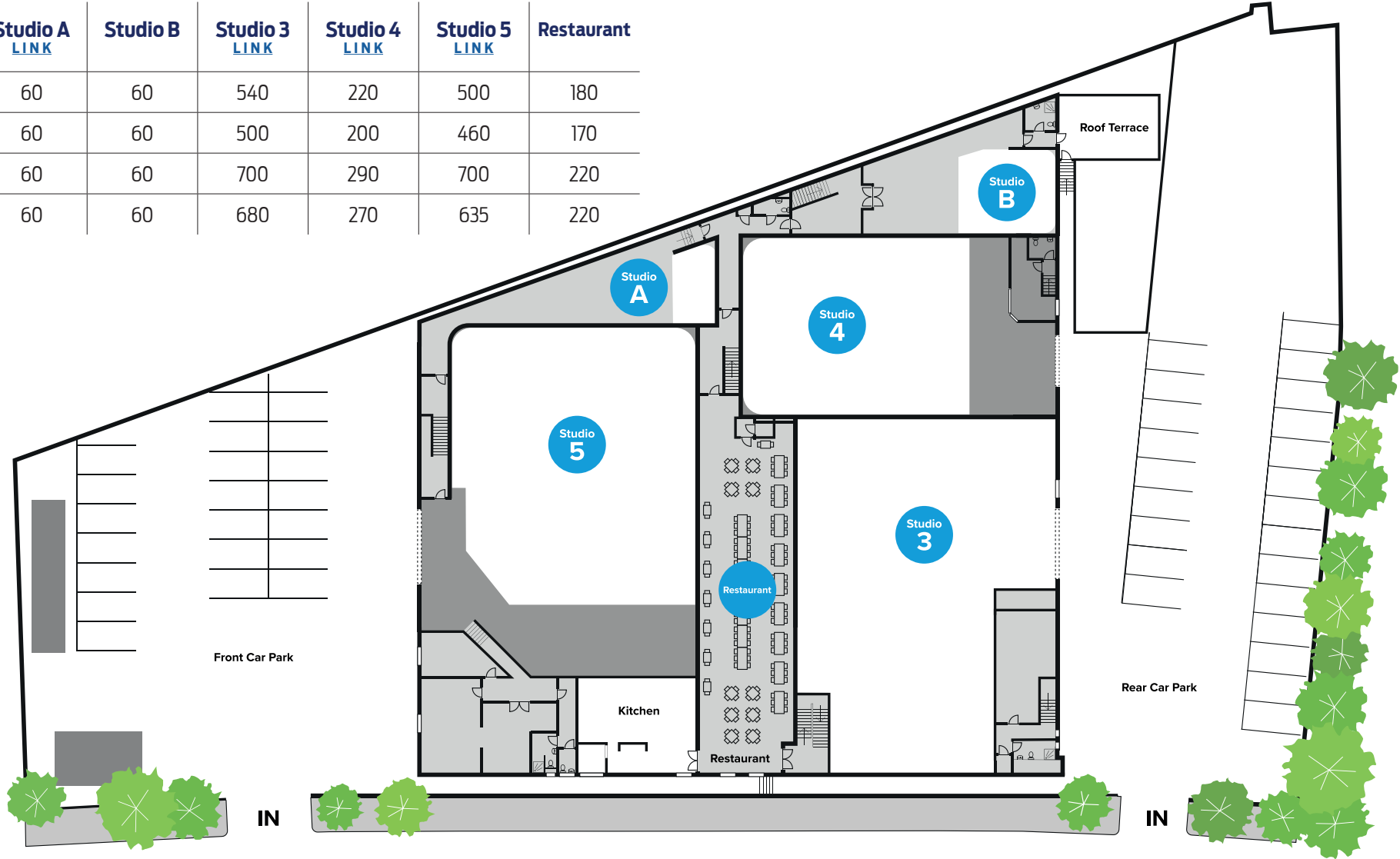

## Barretts Green Road

\* If more than one studio is hired capacities will vary depending on event type and combination of studios used.  
\*\* A fire safety management plan will be created to enable the safe management of events.  
The maximum capacity for each event will be calculated according to the specific requirements of each event.





For more information or to  
arrange a site visit contact:  
**[kate@parkroyalstudios.com](mailto:kate@parkroyalstudios.com)**  
**020 8965 9778**